

WALLBOX 20FT W/TWIN STORAGE

PRODUCT CATEGORY: WALLBOX DISPLAYS
PRODUCT CODE: WB-20-TS



On Frame

OnGraphic

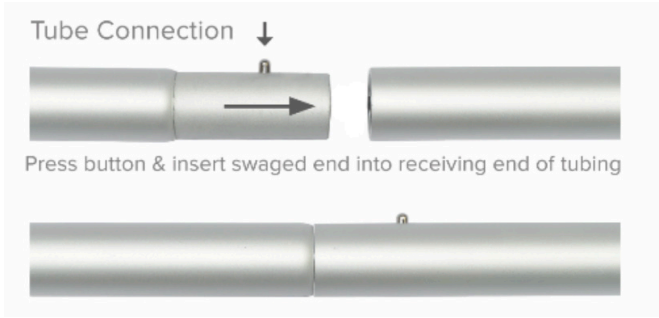

INCLUDES TRAVEL BAG
SKU: AIR-BAGWHL

PRODUCT DESCRIPTION

Introducing the Wallbox 20ft with Storage – a sophisticated solution for dynamic presentations and efficient storage integration. Crafted with precision and innovation, this tubular backwall display seamlessly combines a spacious 20ft canvas with a versatile 90° extensions on each end, enhancing both your exhibit’s aesthetics and functionality.

Design and Construction:

The Wallbox 20ft boasts a sleek tubular design, featuring a 30mm diameter with an elegant anodized silver finish. Its tool-free assembly system, enabled by spring push-button connections, ensures hassle-free setup, allowing you to focus on your presentation with ease.

Graphics and Wrapping:

Immerse your audience in captivating visuals with our dye-sublimated fabric graphics. The pillowcase-style finishing offers a seamless wrap-around effect, covering the front, back, and both end caps of the frame. A solid white fabric adorns the top and bottom, framing your message with clarity and sophistication.

Storage Integration:

Effortlessly transition from presentation to organization with the integrated storage area. Positioned discreetly within the 90° extensions, accessing your materials is as simple as unzipping the opening, placing your contents inside, and securely zipping it closed. Say goodbye to clutter and hello to streamlined professionalism.

Dimensions and Portability:

With dimensions measuring 20ft W x 7.5ft Hx 4ft D, the Wallbox 20ft offers ample space for your visual narrative while maintaining a compact footprint. Additionally, the inclusion of a travel bag ensures convenient transportability, making it the perfect companion for trade shows, exhibitions, and beyond.

Customization Options:

Tailor your display to reflect your unique brand identity with our customization services. Whether it’s color schemes, branding elements, or additional features, our team is dedicated to bringing your vision to life, ensuring your display stands out amidst the crowd. Elevate your presentations with the Wallbox 20ft with Storage – where innovation meets functionality, and style meets substance.

DISPLAY DIMENSIONS	240"W x 90"H x 48"D
GRAPHIC MATERIAL	
Dye Sublimated Stretch Fabric	
GRAPHIC FINISHING	
Pillowcase graphic finishing with #10 zipper closure across top of display. There is an additional zipper on the storage are to access contents inside. Graphic panels are dye sub printed on stretch fabric. Bottom panel will always be black fabric. Top panel on single sided graphics will always match the back. Double sided graphics will always have a black top panel.	
DISPLAY CONSTRUCTION	
30mm aluminum tubing with plastic connectors	
SHIPPING WEIGHTS & DIMENSIONS	
Shipping Weight	88 lbs (Graphic Package) 72 lbs (Hardware Only) 16 lbs (Graphic Only)
Shipping Dimensions	70" L x 11" W x 11" H (Graphic Package) 70" L x 11" W x 11" H (Hardware Only) Poly Bag (Graphic Only)

WALLBOX 20FT W/TWIN STORAGE

PRODUCT CATEGORY: WALLBOX DISPLAYS
PRODUCT CODE: WB-20-TS



On Frame

OnGraphic

ADDITIONAL IMAGES

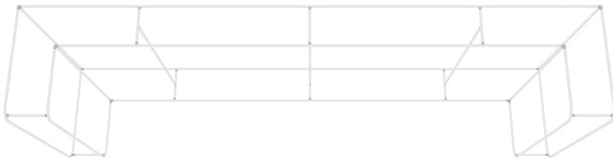
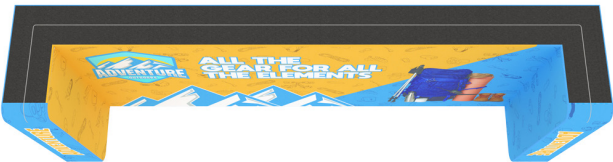
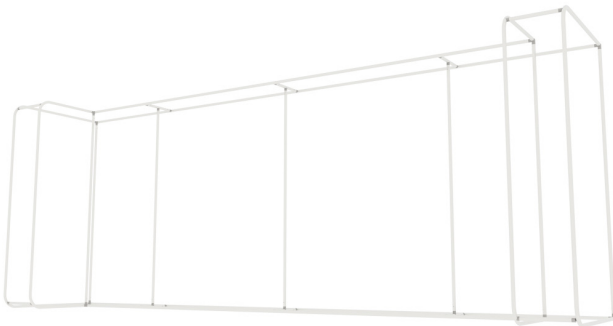
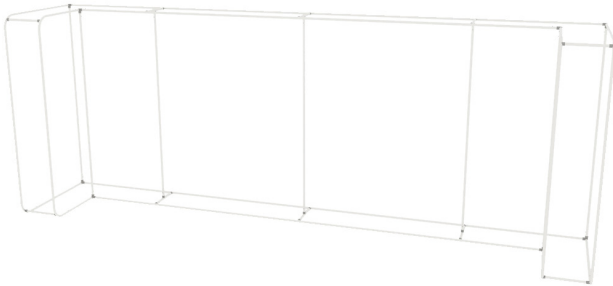

WALLBOX 20FT W/TWIN STORAGE

PRODUCT CATEGORY: WALLBOX DISPLAYS
PRODUCT CODE: WB-20-TS



On Frame

OnGraphic

BACK AND TOP FABRIC COLORS

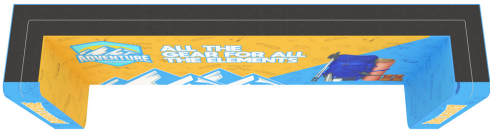
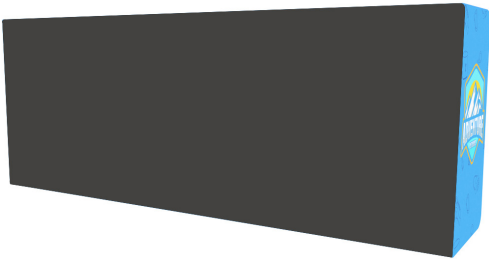

Single Sided Black Back Fabric

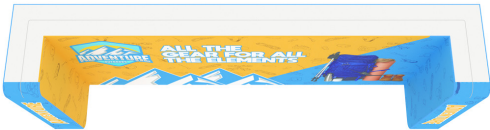
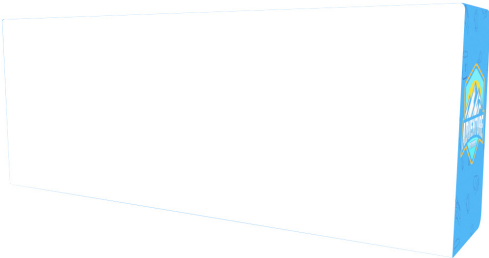

Single Sided White Back Fabric

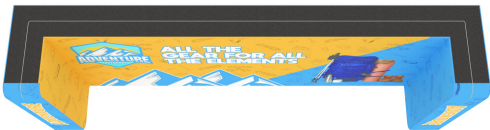

Double Sided (Top is Always Black)

WALLBOX 20FT W/TWIN STORAGE

PRODUCT CATEGORY: WALLBOX DISPLAYS

PRODUCT CODE: WB-20-TS



On Frame

On Graphic

STORAGE AREA DETAILS



Storage area is located on the left and right hand sides of the display and is accessed via a zipper on the front face of the graphic. The zipper opens from the bottom up, starting from the corner where the front graphic meets the storage area and runs up along the end cap seam. Zipper color is white so keep that in mind when designing graphics.

WALLBOX 20FT W/TWIN STORAGE

PRODUCT CATEGORY: WALLBOX DISPLAYS

PRODUCT CODE: WB-20-TS



On Frame

OnGraphic

SET UP INSTRUCTIONS/ PARTS LIST

REFERENCE LABELS ON TUBES WITH DIAGRAM BELOW FOR FRAME ASSEMBLY

OUTER FRAME ASSEMBLY

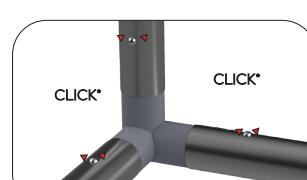
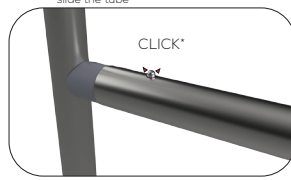
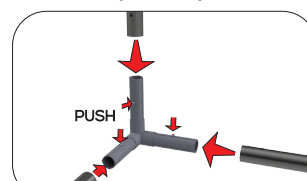
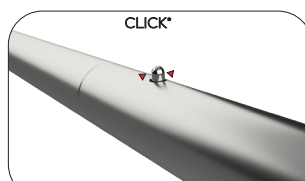
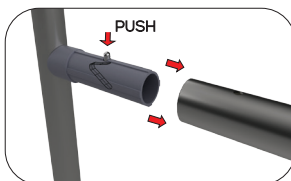
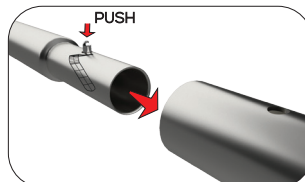
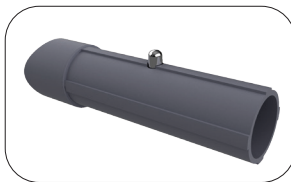
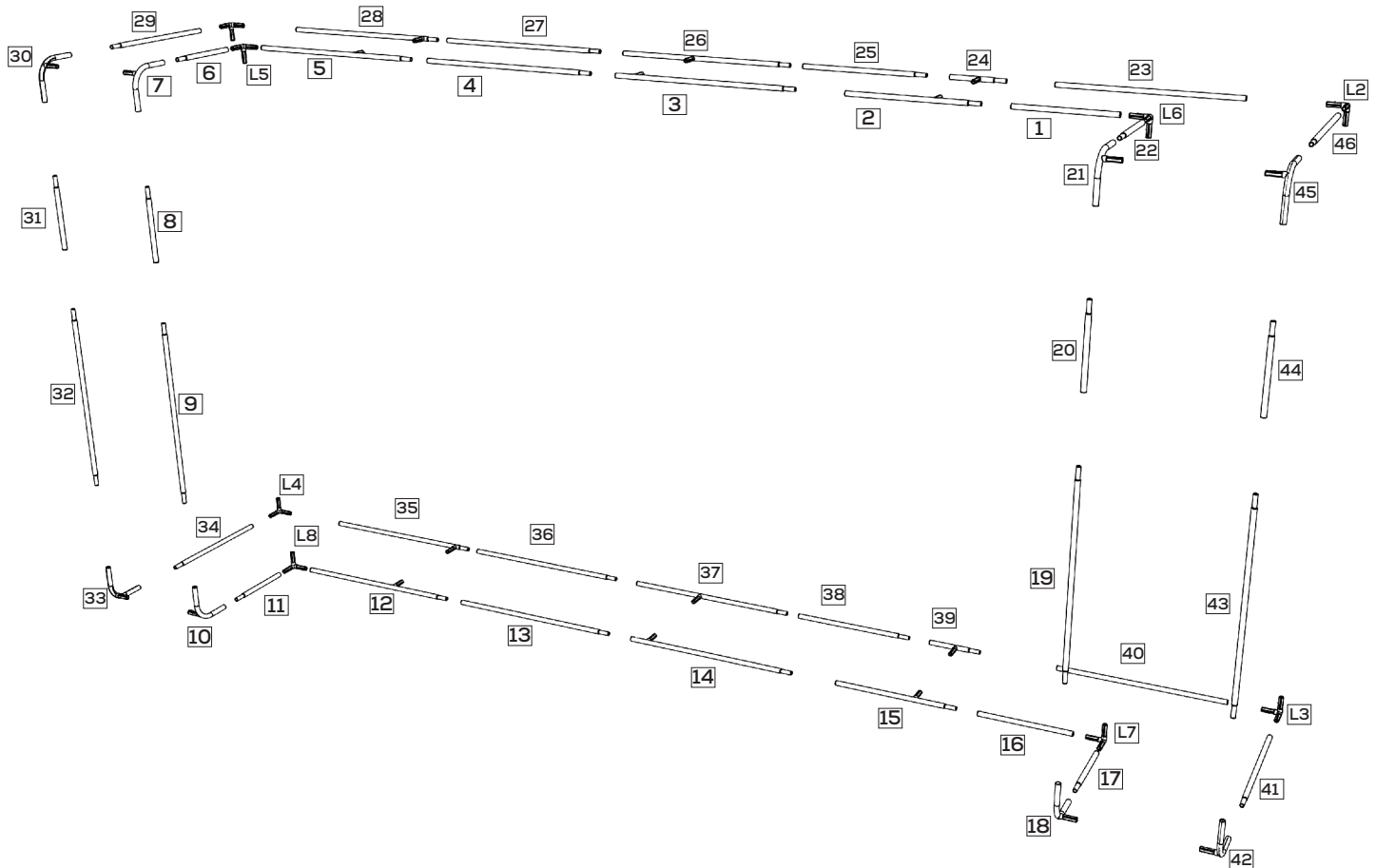

WALLBOX 20FT W/TWIN STORAGE

PRODUCT CATEGORY: WALLBOX DISPLAYS

PRODUCT CODE: WB-20-TS



On Frame

OnGraphic

SET UP INSTRUCTIONS/ PARTS LIST

SUPPORT STRUT INSTALLATION

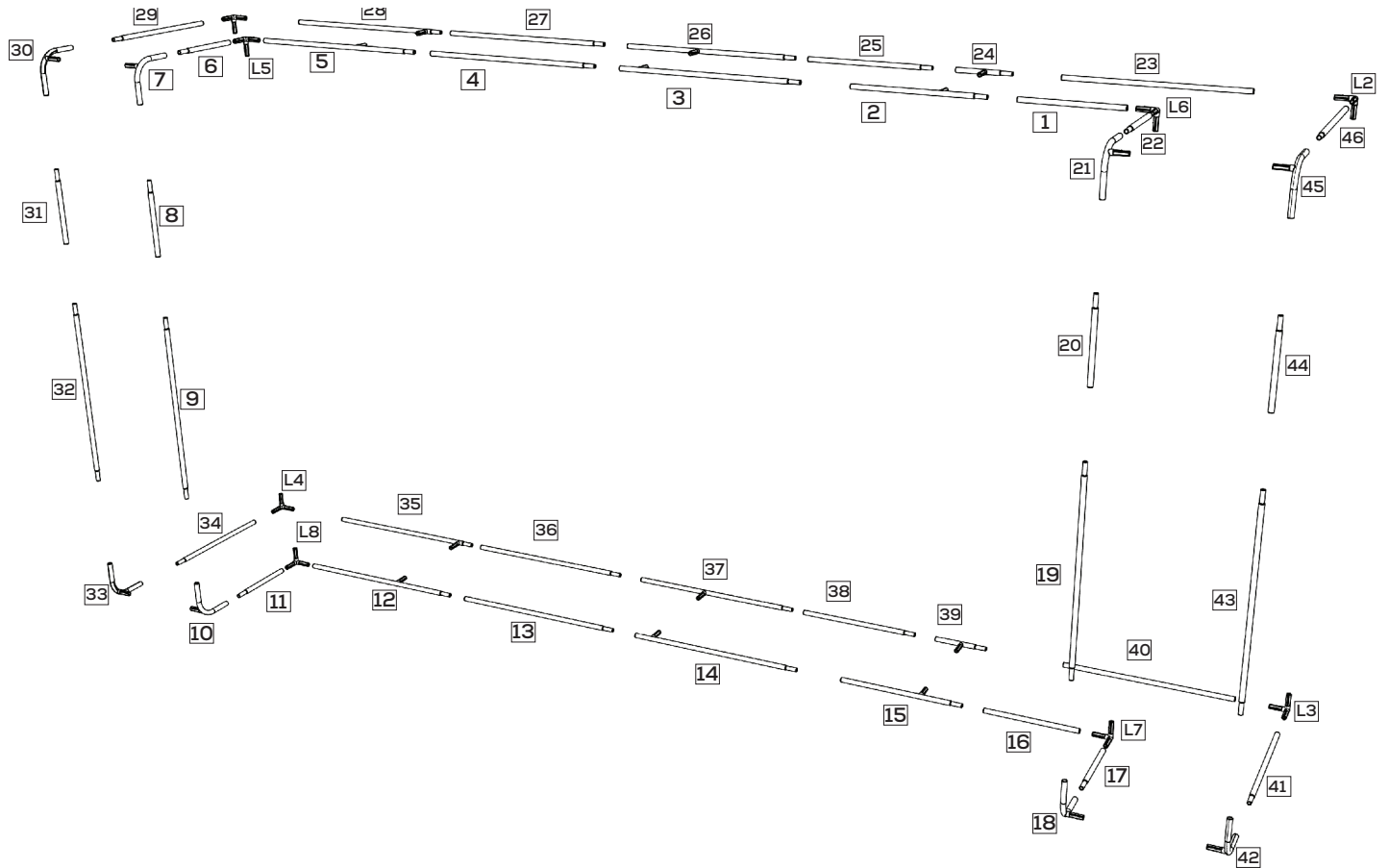

WALLBOX 20FT W/TWIN STORAGE

PRODUCT CATEGORY: WALLBOX DISPLAYS

PRODUCT CODE: WB-20-TS



On Frame

OnGraphic

TEMPLATE GUIDE

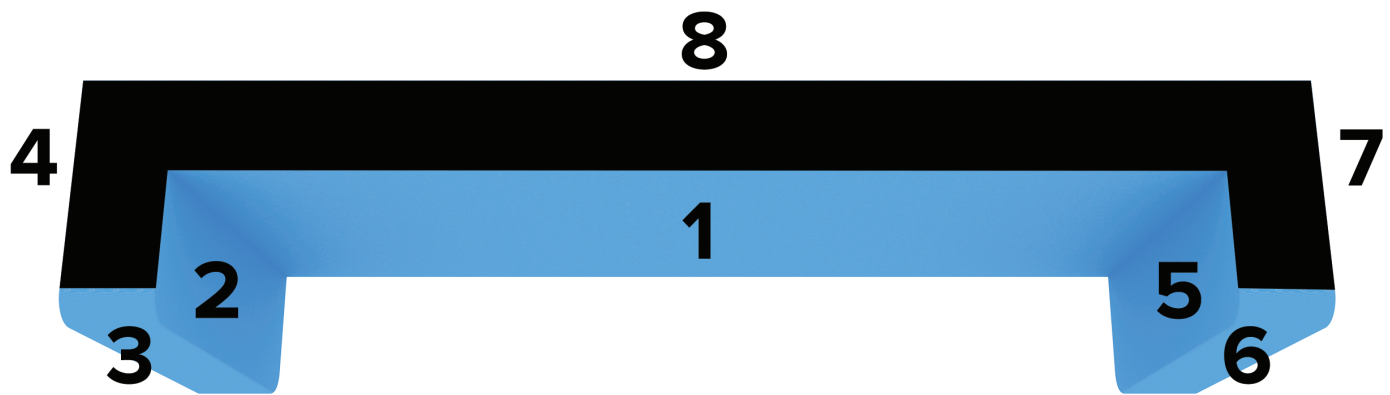
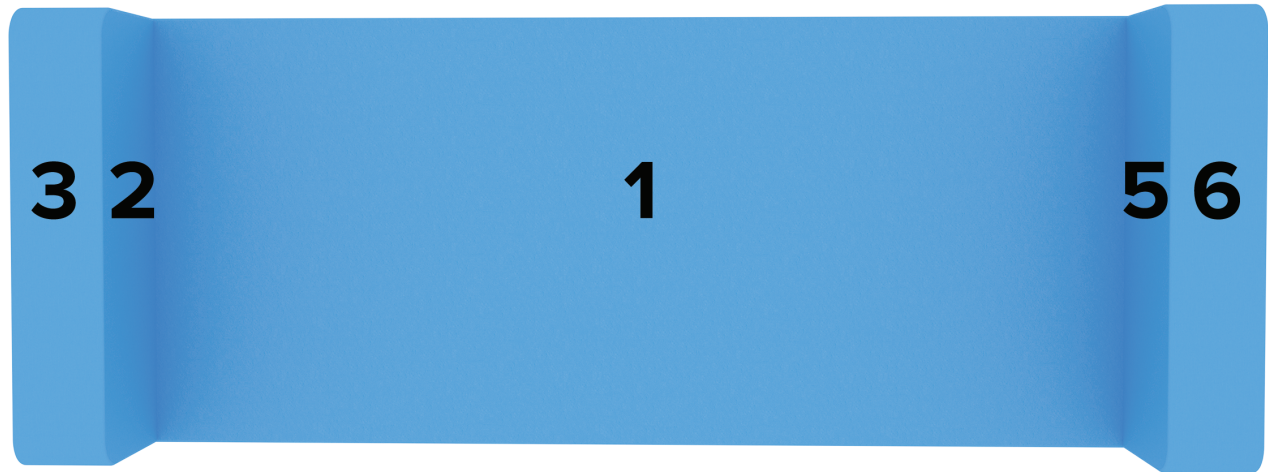

- 1. Main Panel Front
- 2. Left Storage Front
- 3. Left Storage End Cap
- 4. Left Storage Back

- 5. Right Storage Front
- 6. Right Storage End Cap
- 7. Right Storage Back
- 8. Main Panel Back

NUMBERS ON THE IMAGE ABOVE INDICATE THE TEMPLATE LOCATION # ON FRAME
PLEASE ADD TEMPLATE LOCATION # TO END OF FILENAME. EX: "WB-20-TS-1"
TOP AND BOTTOM PANELS WILL BE STOCK BLANK FABRIC