

VAIL 120DB 20ft Backlit

The VAIL-120DB 20ft Wide BACKLIT Freestanding Display is designed for impactful, illuminated presentations, perfect for events, trade shows, and retail environments. Featuring a robust, silver anodized aluminum profile extrusion, this display utilizes the VAIL-120DB profile, measuring 120mm wide (4.7 inches), providing excellent structural support and a sleek finish.

This system is designed to showcase custom dye-sublimated backlit fabric graphics with SEG (Silicone Edge Graphic) finishing for fast and easy graphic installation and swap-outs. The frame is illuminated by LED edge lights positioned along the top and bottom, delivering even, vibrant lighting across your graphics. Installation is hassle-free with plug-and-play LED lights and a transformer.

The VAIL-120DB display is capable of presenting single or double-sided graphics, making it versatile for various promotional setups. It's available in 8ft and 10ft heights, giving you flexibility for different environments and applications. Side-mounted and bottom-mounted feet provide stability, ensuring your display remains secure, even in high-traffic areas.



OVERVIEW

- Large 20ft wide freestanding silver anodized aluminum extrusion frame
- Illuminated with LED Edge Lights (RESORT-LS)
 - 15 light strips along top frame profile
 - 15 light strips along bottom frame profile
 - Light strips mount to spine of VAIL-12DB profile
- Features a 120mm wide (VAIL-120DB) frame profile
- 3 vertical struts
- Easy frame assembly
 - Tool free corner and frame split connection
 - Vertical struts installation requires 4mm allen key which is included
- Available in standard 8ft and 20ft heights
- Capable of single and double sided graphic display
- Displays dye sublimated SEG (Silicone Edge Graphics)
 - (2 graphics - 1 front/1 back)
- 4 stabilization feet for stability
 - 2 Side mounted
 - 2 bottom mounted
- Frame size customization is available
- Backlit option is available

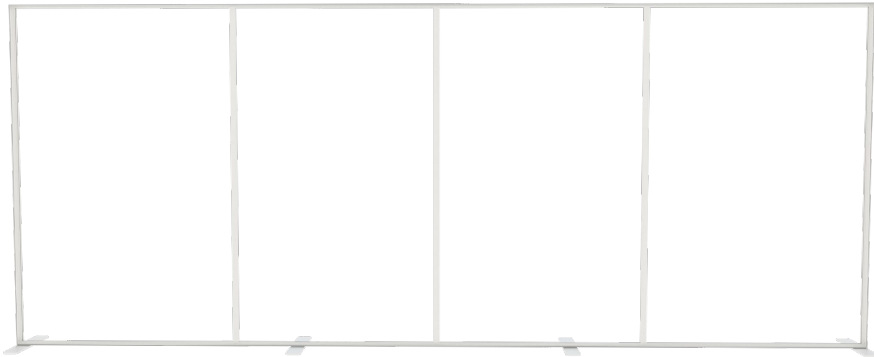

SEG Graphic Installation



LED Edge Lights

IMAGES



VAIL-120DB Backlit 20ft W x 8ft H



VAIL-120DB Backlit 20ft W x 10ft H

- VAIL-120DB-BL-20x-8-G1 - VAIL-120DB 20ft W x 8ft H Backlit Single Sided Graphic Package
 - VAIL-120DB-BL-20x-8-G2 - VAIL-120DB 20ft W x 8ft H Backlit Double Sided Graphic Package
 - VAIL-120DB-BL-20x-8-GO1 - VAIL-120DB 20ft W x 8ft H Backlit Single Sided Graphic Only
 - VAIL-120DB-BL-20x-8-GO2 - VAIL-120DB 20ft W x 8ft H Backlit Double Sided Graphic Only
 - VAIL-120DB-BL-20x-8-HO - VAIL-120DB 20ft W x 8ft H Backlit Hardware Only
 - VAIL-120DB-BL-20x-10-G1 - VAIL-120DB 20ft W x 10ft H Backlit Single Sided Graphic Package
 - VAIL-120DB-BL-20x-10-G2 - VAIL-120DB 20ft W x 10ft H Backlit Double Sided Graphic Package
 - VAIL-120DB-BL-20x-10-GO1 - VAIL-120DB 20ft W x 10ft H Backlit Single Sided Graphic Only
 - VAIL-120DB-BL-20x-10-GO2- VAIL-120DB 20ft W x 10ft H Backlit Double Sided Graphic Only
 - VAIL-120DB-BL-20x-10-HO- VAIL-120DB 20ft W x 10ft H Backlit Hardware Only
- 

HARDWARE DETAILS



The lightbox frame is made from the VAIL-120DB Resort Extrusion profile. The VAIL-120DB is a 120mm/4.7in wide silver anodized aluminum extrusion profile designed for double sided graphic display and accepts 12mm x 3mm keder (silicone beading)



Each frame features 2 feet Side Mounted Feet (VAIL-SF) which are 24in L x 4in W. Each foot attaches to the frame via 2 bolts w/wing nuts enabling a quick tool free installation.

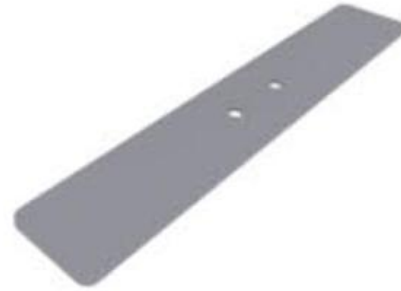

Each frame features 2 feet Bottom Mounted Feet (VAIL-BF) which are 24in L x 4in W. Each foot attaches to the frame via 2 bolts w/wing nuts enabling a quick tool free installation.



Tool free corner locks (RESORT-TFCRNR) are utilized to connect the bottom corners of the frame. Simply slide the lock into the spines of the VAIL-120DB profiles and press down levers to lock them into place.

LED & TRANSFORMER DETAILS

TRANSFORMER SPECIFICATIONS

AC-DC Single output LED driver Mix mode (CV+CC) with built-in PFC;
Output 24Vdc at 10A; IP65; Cable output; Dimming with Potentiometer

Height	38.8 mm
Length	244.2 mm
Width	68 mm
Mounting Style	Panel Mount
Input Voltage	90 VAC to 305 VAC, 127 VDC to 431 VDC
Number of Outputs	1 Output
Open Frame-Enclosed	Enclosed
Output Power	240 W
Industry	Industrial
Output Current-Channel 1	10 A
Output Voltage-Channel 1	24 VDC
Operation Mode	CV + CC
Dimming	Without Dimming
Standard	PSE
IP Rating	IP65
Control Signals	Potentiometer
Dimming Technology	Analog Potentiometer
Certifications	UL Listed

LED STRIP SPECIFICATIONS (PER STRIP)

Power	10 W per strip (2W per LED)
Input Voltage	DC24±0.5V
Color Temperature	6000-7000k
Angle	9°*50°/15°*60°
Certifications	ETL & CE Certifications
Lamp Type	CREE
Lumen	750-800LM (150-160LM *5)
Light Strip Dims	14.5"L x .75"W (L includes wires/connectors)



LED edge lights (SKU: RESORT-LS) are installed on the left and right vertical profiles of frame, along with the top angled profile. There is no lighting on the bottom profile. The edge lights install on the center spine of the VAIL-120DB profile



The transformer for the LED lights (SKU: MAM-TSFM) mounts to the bottom profile of the frame with the included adhesive back hook and loop strips. The power cord is pre wired to the transformer for plug and play application.

GRAPHIC INFO

- **Material:** Backlit Fabric (INV-FAB-BL)
- **Material Roll Width:** 117"
- **Print Process:** Dye Sublimation
- **Finishing:** Silicone Edge Graphic (SEG) finishing with 12mm x 3mm silicone beading sewn to graphic perimeter . A pull tab is sewn into a bottom corner to help with graphic removal
- **Graphic Options:**
 - Graphic Package - Double Sided Only
 - Graphic Only - Single Sided (requires qty 1 front graphic
And qty 1 back graphic to reskin frame)
- **Production Time:** See product page for current production times and location availability



Dye Sub Backlit - OC

Thickness	Printing Process	Finishing	Maximum Media Width
5.25 oz	Dye Sublimation Paper Transfer	Soft Look Bright Colors	117"