

MODCO 34 - 10 X 10

MODCO MODULAR EXHIBITS
PRODUCT CODE: MODCO34-10x10G



PRODUCT DESCRIPTION

Modco® Modular Display 34 is a three-dimensional, pre-designed exhibit ideal for an island booth space. Stylish and dynamic, this booth features a three-sided wall exhibit with an arch located at the front, delivering a stunning look to attract and engage attendees. The structure is built using tool-free perforated modular aluminum frames. Multiple frame sizes connect seamlessly using intuitive, tool-less pin connectors, making assembly quick and efficient.

DISPLAY DIMENSIONS		117"W X 126"H X 117"D
GRAPHIC SIZES	SIZE	QTY
	117"W x 95.2"H	6
	39"W x 95.2"H	2
	39.6"W x 31"H	2
	39.6"W x 27.75"H	2
	TOTAL	12

GRAPHIC MATERIAL

Stretch Fabric w/ Integrated Block Out

GRAPHIC FINISHING

Silicone beading is sewn around the perimeter of the fabric graphic. Silicone beading is hidden from view once installed.

DISPLAY CONSTRUCTION

Aluminum frame and components

SHIPPING WEIGHTS & DIMENSIONS (FREIGHT ONLY)

Shipping Weight	290lbs (on pallet)
Shipping Dimensions	40"W x 104"D x 18"H

GRAPHIC TURN AROUND TIME

4 business days after proof approval

AVAILABILITY	PFC / PA
--------------	----------

MODCO 34 - 10 X 10

MODCO MODULAR EXHIBITS
PRODUCT CODE: MODCO34-10x10G

PARTS REFERENCE

Parts List



992 x 2418
MOD-FRM-992x2418
Qty.10



774 x 992
MOD-CRVFRM-774x992
Qty.2

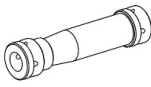

Clamp Connector
MOD-CLA-CON
Qty.20



90° Connector
MOD-90D-CON
Qty.4

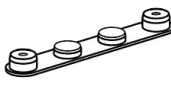

180° Connector
MOD-180D-CON
Qty.10

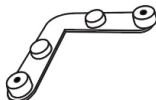

Small 90° Connector
MOD-SM90D-CON
Qty.4



Pin Connector
MOD-PC
Qty.48

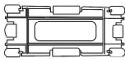

Clip Connector
MOD-CC
Qty.18



1/4 Curved Cover Profile
MOD-CP-774
Qty.4



28mm Screw Nut
MOD-SN28MM
Qty.8



95° Cover Profile
MOD-CP-992x2418
Qty.4

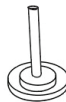

Pin Connector for Profile Cover
MOD-PCWP-B
Qty.8

MODCO 34 - 10 X 10

MODCO MODULAR EXHIBITS
PRODUCT CODE: MODCO34-10x10G

INSTRUCTIONS

Modco 34 - 10x10



MODCO 34 - 10 X 10

MODCO MODULAR EXHIBITS
PRODUCT CODE: MODCO34-10x10G

INSTRUCTIONS

Modco 34 - 10x10

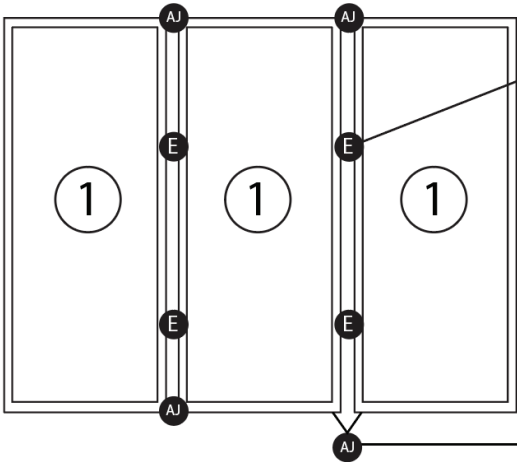

REF (E)
MOD-CLA-CON

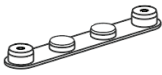
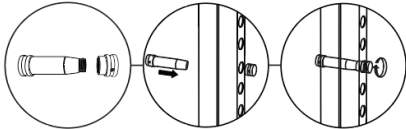

REF (AJ) / (B)
MOD-180D-CON / MOD-PC

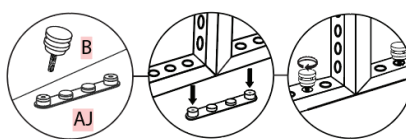

REF	QTY	PART NO.	DESCRIPTION
1	9	MOD-FRM-902x2418	Straight Frame, Corner Screw Connect 902mm x 2418mm
B	40	MOD-PC	Pin Connector
C	4	MOD-90D-CON	90°Connector
D	4	MOD-90D-CON	90°Connector
E	12	MOD-CLA-CON	Clamp Connector
AJ	10	MOD-180D-CON	180 Degree Connector

MODCO 34 - 10 X 10

MODCO MODULAR EXHIBITS
PRODUCT CODE: MODCO34-10x10G

INSTRUCTIONS

Modco 34 - 10x10

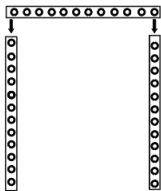
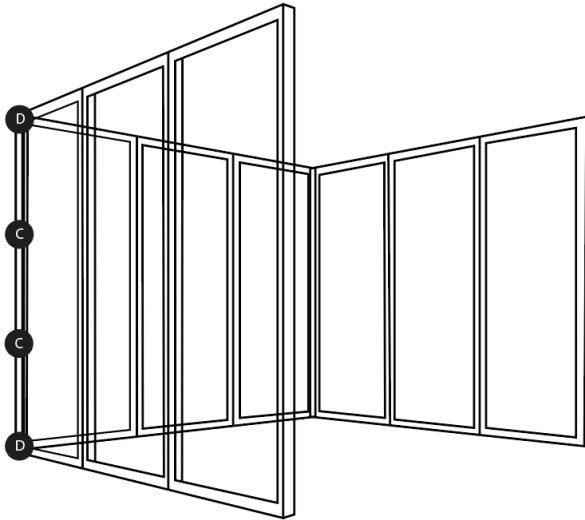
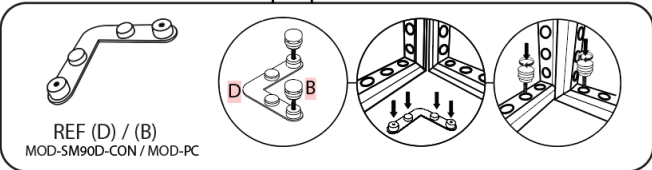
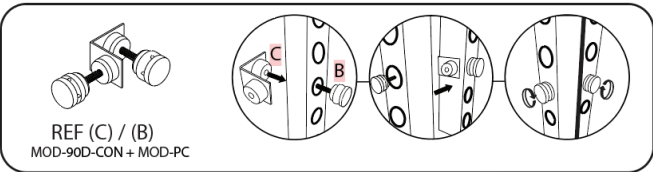
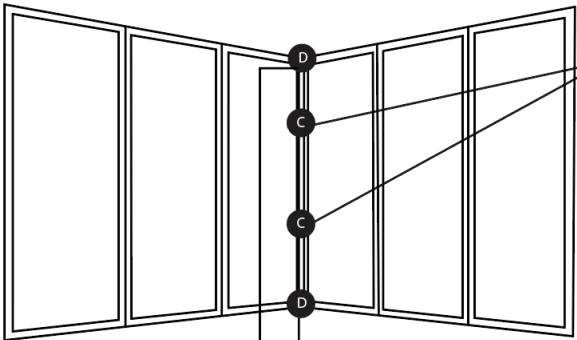

TOP VIEW OF ROOM

MODCO 34 - 10 X 10

MODCO MODULAR EXHIBITS
PRODUCT CODE: MODCO34-10x10G

INSTRUCTIONS

Modco 34 - 10x10

REF (B) or (C) / (A)
MOD-CRV-180DCLR / MOD-PC

REF (D)
MOD-CLA-CON

REF	QTY	PART NO.	DESCRIPTION
1	1	MOD-FRM-952C2418	Straight Frame, Corner Screw Connect 952mm x 2418mm
2	2	MOD-CRV-FRM-774x992	Curved Frame, 774mm x 992mm
A	12	MOD-PC	Pin Connector
B	3	MOD-CRV-180DCLR	Modco Curve 180 Degree Connector (Left)
C	3	MOD-CRV-180DCR	Modco Curve 180 Degree Connector (Right)
D	8	MOD-CLA-CON	Clamp Connector

MODCO 34 - 10 X 10

MODCO MODULAR EXHIBITS
PRODUCT CODE: MODCO34-10x10G

INSTRUCTIONS

Modco 34 - 10x10

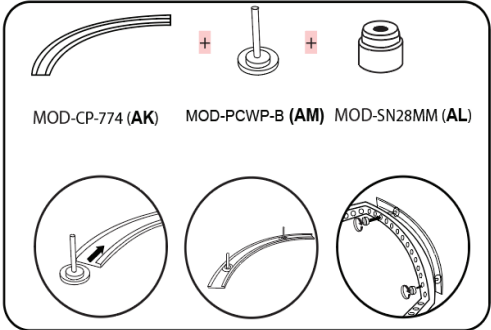
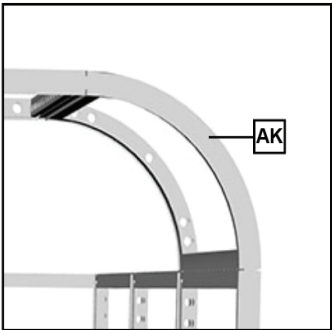
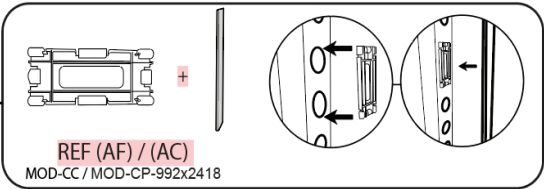
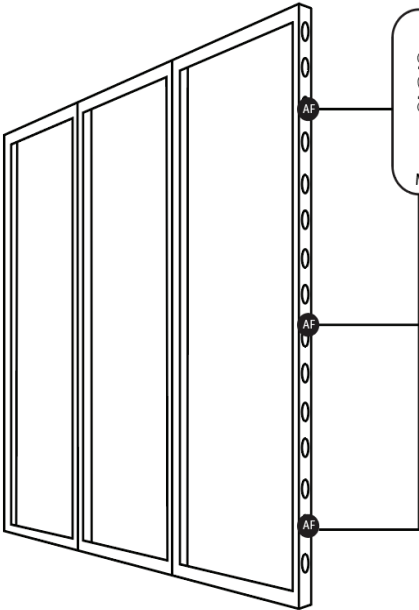

COVER PROFILES & ACCESSORIES			
REF	QTY	PART NO.	DESCRIPTION
AC	4	MOD-CP-992x2418	Cover Profile for Frame 992x2418. Flat Model. Anodized
AF	18	MOD-CC	Clip Connector Cover Connects Cover Profile
AL	44	MOD-FP	Modco Frame Protector

COVER PROFILES & ACCESSORIES			
REF	QTY	PART NO.	DESCRIPTION
AK	4	MOD-CP-774	Cover Profile for Frame 774x992. Flat Model. Anodized
AL	8	MOD-SN28MM	Clip Connector Cover Connects Cover Profile
AM	8	MOD-PCWP-B	Modco Frame Protector

MODCO 34 - 10 X 10

MODCO MODULAR EXHIBITS

PRODUCT CODE: MODCO34-10x10G

GRAPHIC REFERENCES

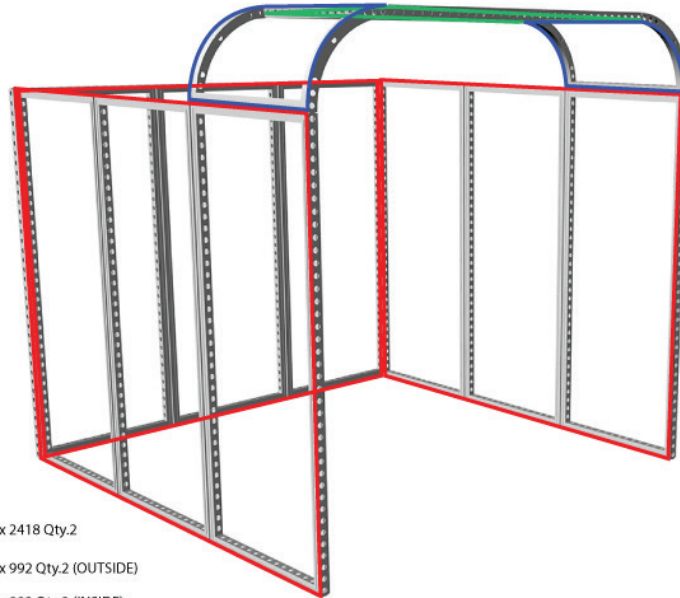

-  992 x 2418 Qty.2
-  774 x 992 Qty.2 (OUTSIDE)
-  774 x 992 Qty.2 (INSIDE)
-  2976 x 2418 Qty.6

GRAPHIC INSTALL



Place graphic over the front of the frame.

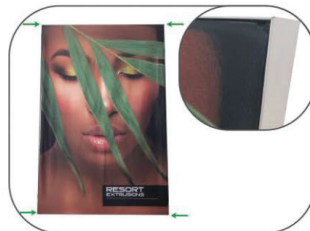

Begin inserting SEG beading at each corner.

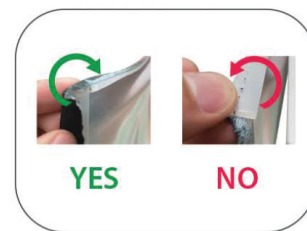

YES

NO

Insert the silicone beading with the fabric folded over. The silicone beading should not be exposed.

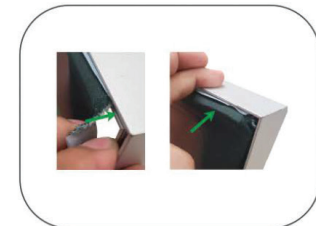

Using your fingers, push both fabric and silicone beading completely into the extrusions channel.

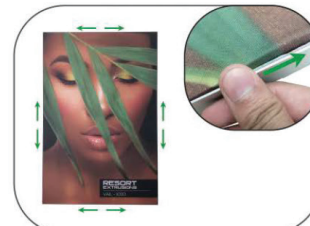

Continue to push in the remaining silicone beading on each side.



Check the perimeter of the frame for any excess beading that hasn't been pushed in. Graphic should be taut.