

LUMIÈRE CONFIGURATION - F W/DUAL EDGE LIGHTS

LUMIÈRE LIGHT WALL
PRODUCT CODE: LLWF20X15EDGE



SET UP INSTRUCTIONS

Pop Up Frame Assembly



a. Place frame with the adjustable feet facing down.

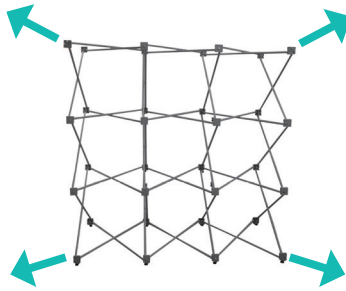

b. Expand the frame.

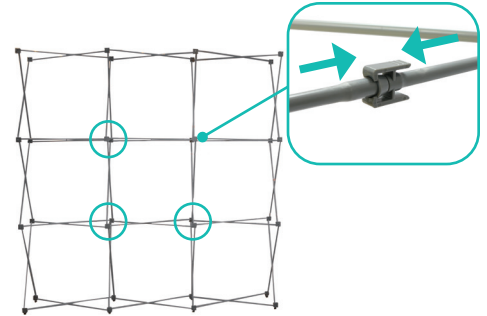

c. Close frame by pushing the outside of the frame until male and female ends connect.

Install Channel Bars

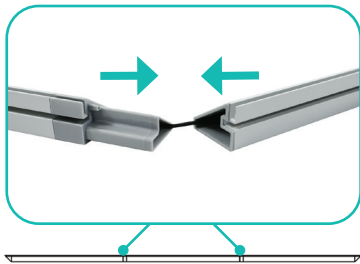

a. Expand each channel bar. Follow bungee to connect.

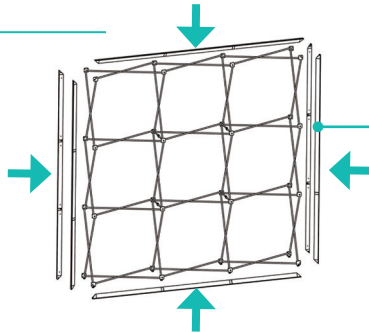

b. Attach channel bars to frame.

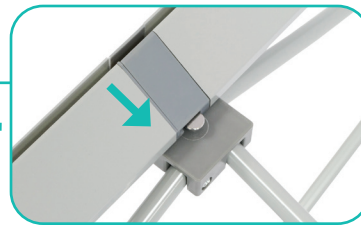

c. Slide channels bars onto frame, from top to bottom, then secure onto metal peg.



d. Attach the top and bottom end caps on each side of the frame.

Dual Edge Light Installation

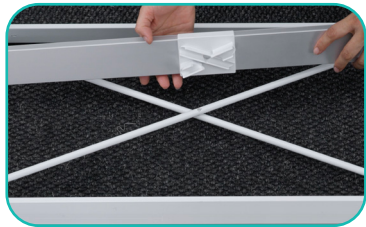

a. Clip dual edge lights to bottom X braces of frame. There should be 1 light strip per section of the frame.

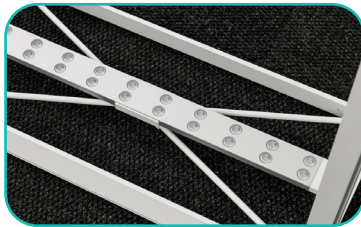

b. Plug Y cables into ports on the ends of the edge light strips. Each Y cable will connect two led strips together. Plug each Y cable into the transformers to complete dual edge light wiring.



Graphic Installation



a. Starting in each corner, insert the silicone edge beading into the grooves of the channels bars



b. Insert the remainder of the beading and work your way across the frame



c. Repeat installation process for back panel, end caps, and blockout panel across the top of the frame.

SET UP INSTRUCTIONS

Connecting Wall

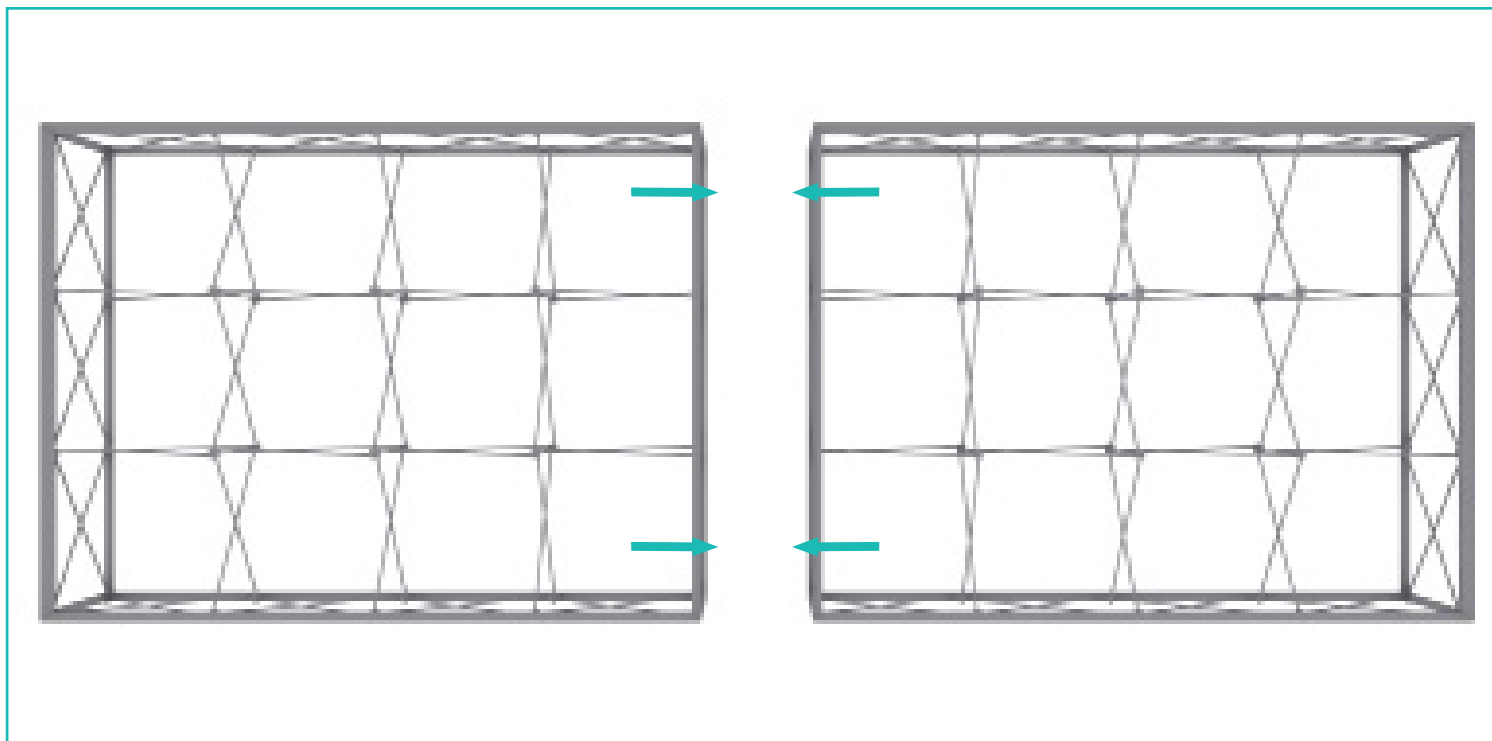

Place the (2) 4x3 frames side by side.

Note: Rendering shown without graphics for clarity.

Straight Connection



*Starting from behind, make sure the frames are flushed next to each other.

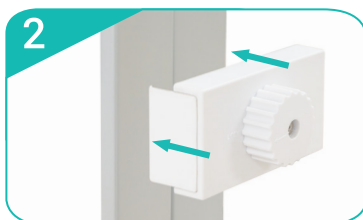

Slide Straight Connector onto the channel bars of both frames.

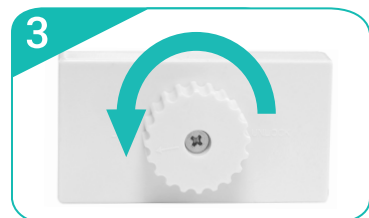

Turn dial to the left to lock the Straight Connector in place. Repeat for each vertical sections (6 total).

Note: Repeat process when frames are stack together (6 total).

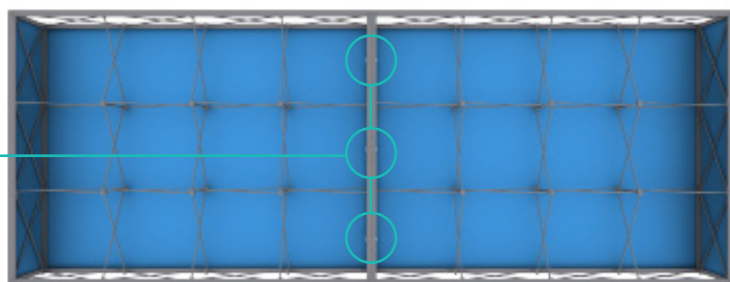

*Back side of the 4x3's shown above.

SET UP INSTRUCTIONS

Connecting Top Walls

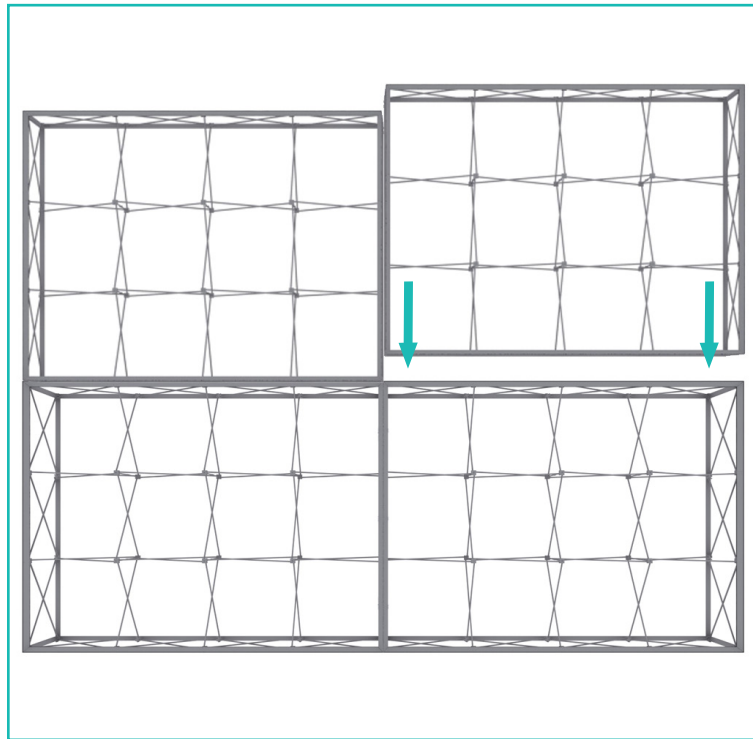
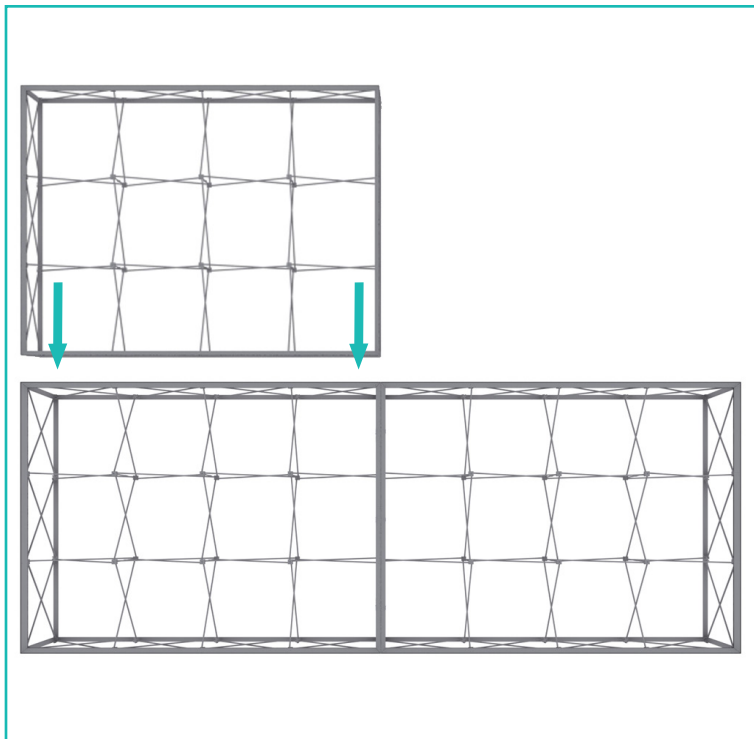

Place the 4x3 frames on top of the 4x3 frames.

Note: 2 people are required to hold each side of the top frame while the third person secures with the Straight Connectors. Repeat process for other top frame.

Note: Rendering shown without graphics for clarity. 4x3 front side graphics must be installed first before placing the frames on top.

Straight Connection



*Starting from behind, make sure the frames are flushed next to each other.

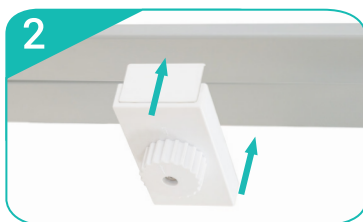

Slide Straight Connector onto the channel bars of both frames.

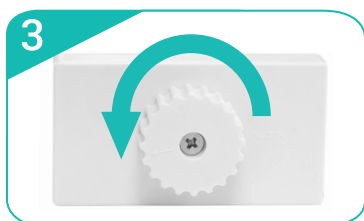

Turn dial to the left to lock the Straight Connector in place. Repeat for each vertical sections (8 total).

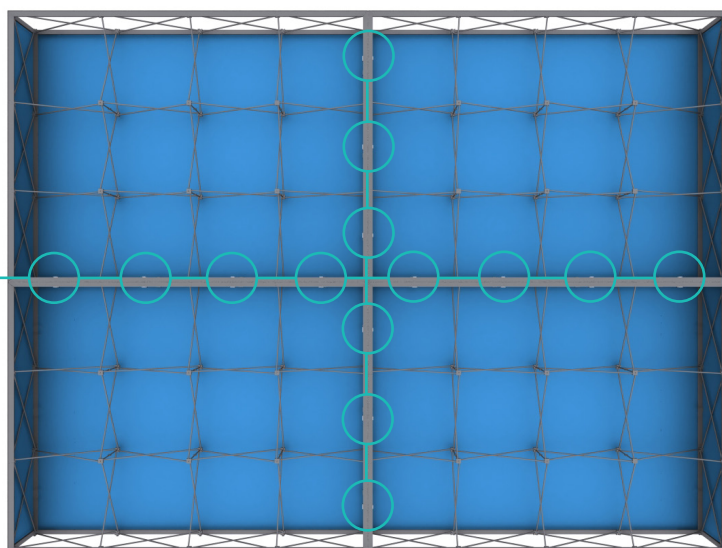

*Back side of the stacked 4x3 frames shown above.

SET UP INSTRUCTIONS

Connecting Return Walls

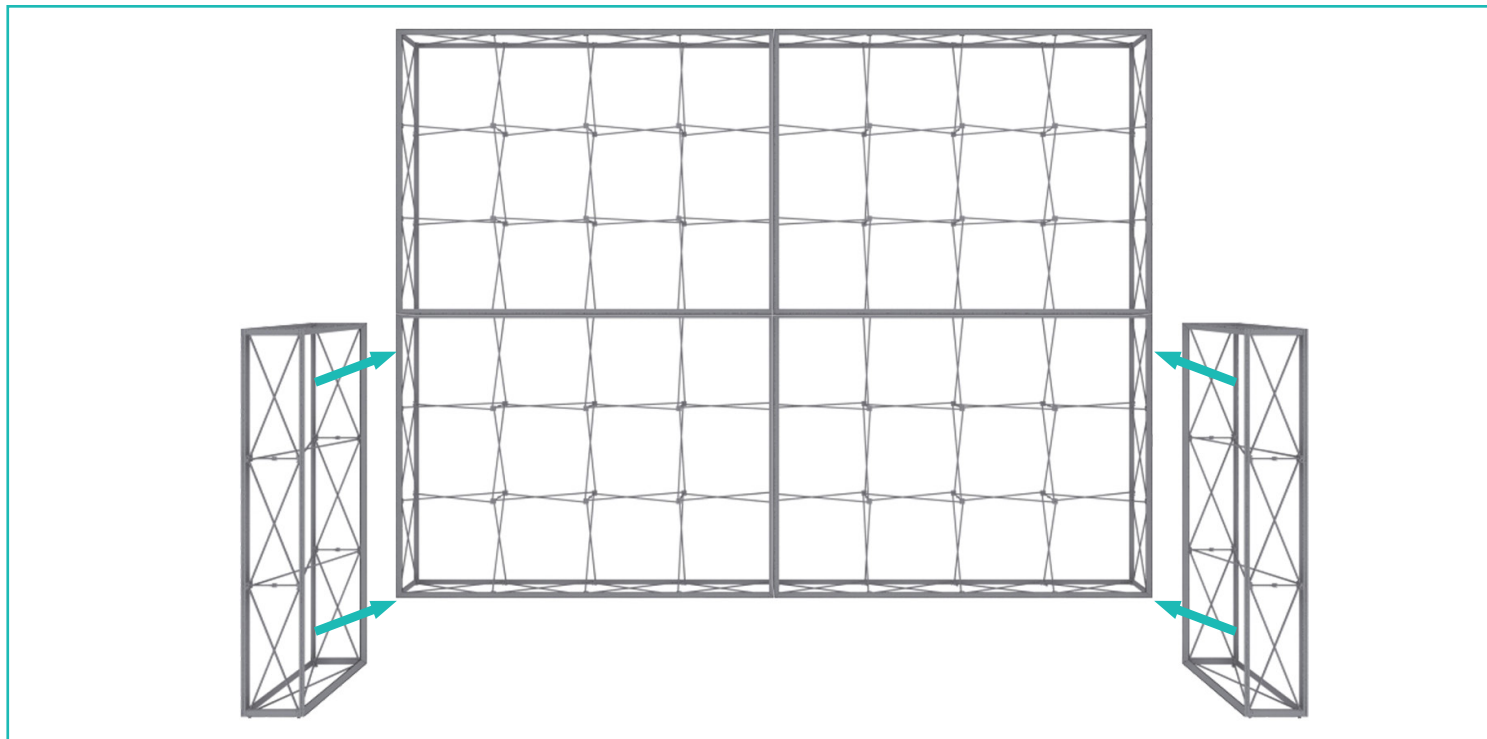

Adjoin the 1x3 frame perpendicular (90° angle) to the front side of the 4x3 frame.

Note: Rendering shown without graphics for clarity. 4x3 front side graphic must be installed before connecting frames.

L Link Connection



*Starting from behind, pull the 4x3 graphic away to make space for L Connector.



Slide L Connector onto the channel bars of both frames.

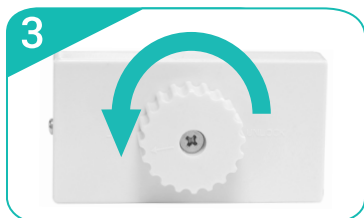

Turn dial to the left to lock the L Connector in place. Repeat for each vertical section (6 total).

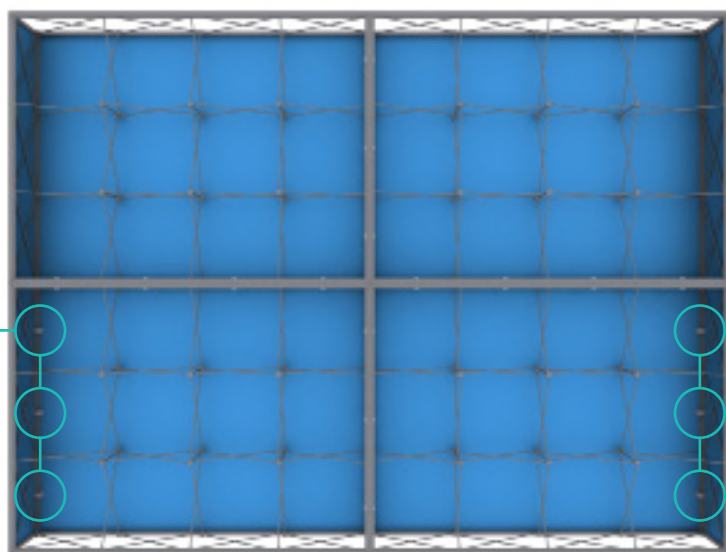

*Back side of 4x3 shown above.